

STATE	STATE PROJECT REFERENCE NO.	SHEET NO.	TOTAL SHEETS
N.C.	DF18314.2044195	RW01	5

TIP PROJECT: DF18314.2044195

STATE OF NORTH CAROLINA
DIVISION OF HIGHWAYS

SURVEY CONTROL, EXISTING CENTERLINES,
RIGHT OF WAY, EASEMENTS AND PROPERTY TIES

HAYWOOD COUNTY

LOCATION: SR 1212 (JOHNSON BRANCH RD) OVER CAMPBELL CREEK
TYPE OF WORK: GRADING, DRAINAGE, PAVING, AND STRUCTURE

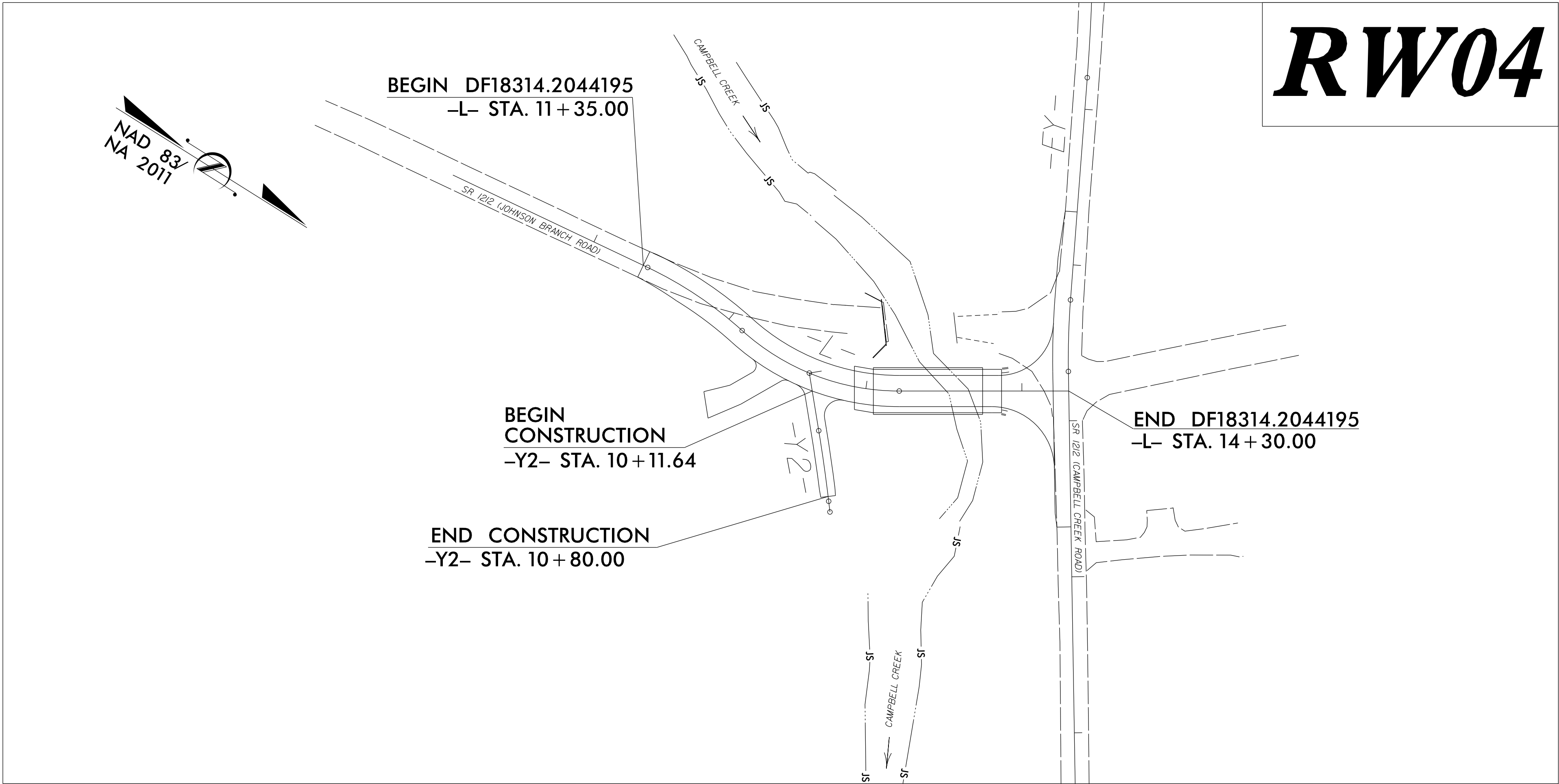

DOCUMENT NOT CONSIDERED FINAL
UNLESS ALL SIGNATURES COMPLETED

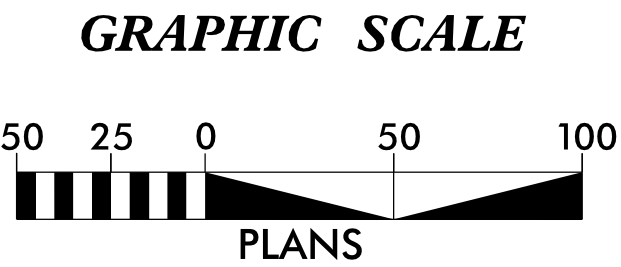

DATUM DESCRIPTION

THE LOCALIZED COORDINATE SYSTEM DEVELOPED FOR THIS PROJECT IS BASED ON THE STATE PLANE COORDINATES ESTABLISHED BY NCGS FOR MONUMENT "GPS 102" WITH NAD 83/NA 2011 STATE PLANE GRID COORDINATES OF NORTHING: 667,145.9630(ft) EASTING: 780,084.8237(ft) ELEVATION: 3,055.42(ft) THE AVERAGE COMBINED GRID FACTOR USED ON THIS PROJECT (GROUND TO GRID) IS: 0.99989010 THE N.C. LAMBERT GRID BEARING AND LOCALIZED HORIZONTAL GROUND DISTANCE FROM "GPS 102" TO -L- STATION 11+35.00 IS S 57° 50' 48.5" E 301.83(ft) ALL LINEAR DIMENSIONS ARE LOCALIZED HORIZONTAL DISTANCES VERTICAL DATUM USED IS NAVD 88

Prepared in the Office of:

LOCATION AND SURVEYS, DIVISION 14
122 BONNIE LANE
SYLVA, NC 28779

2018 STANDARD SPECIFICATIONS

RIGHT OF WAY DATE:
SEPTEMBER 10, 2025

LETTING DATE:
JANUARY 27, 2026

PROFESSIONAL LAND
SURVEYOR



DocuSigned by:
Brian Barnatt
K0355FE948A3ACE
SIGNATURE:

12/10/2025
Date:

